

Database repair utility 'pdxrbld.exe'

If Resmanager is reporting "Index out of date" errors try using this utility (or any other errors it can't do any harm). It takes seconds and automatically repairs wherever possible (reports of unrepaired errors to formatted memos can be ignored). Resmanager should work after this repair utility has been run, if not you may need to restore the data folder from a backup.

The pdxrbld.exe data repair application can run on any PC that is running ResManager Version 4.xx (as displayed at the bottom of the ResManager main menu) or any PC that has the "Borland Database Engine" V5.01 or greater 32 bit installed (download [here](#)).

Double-click on pdxrbld.exe (or it may just show pdxrbld). Follow the 4 steps below. Click CLOSE when it has finished.

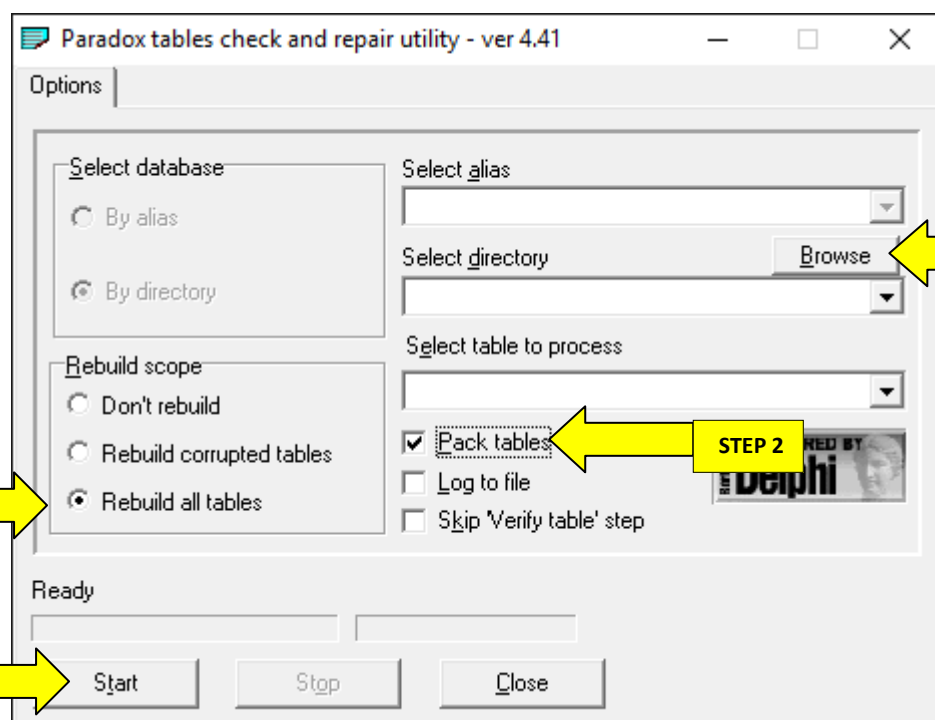

STEP 1

Click the Browse button and select the directory/folder (probably on a network drive) where the Resmanager data is stored (approx 50 files many starting with "app"; the path is recorded in c:\program files\resmanager\resmanl.ini

STEP 2

STEP 3

STEP 4